

Plotted By: Hargrett, Tom Sheet Set: Charlotte Burrie Park Layout: L2.10 LANDSCAPE PLAN December 19, 2023 06:12:55pm K:\WEB_URG\043310008--charlotte burrie park\CAD\plansheets\L2.10 LANDSCAPE PLAN.dwg

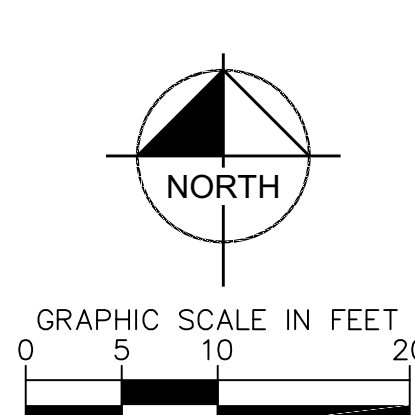
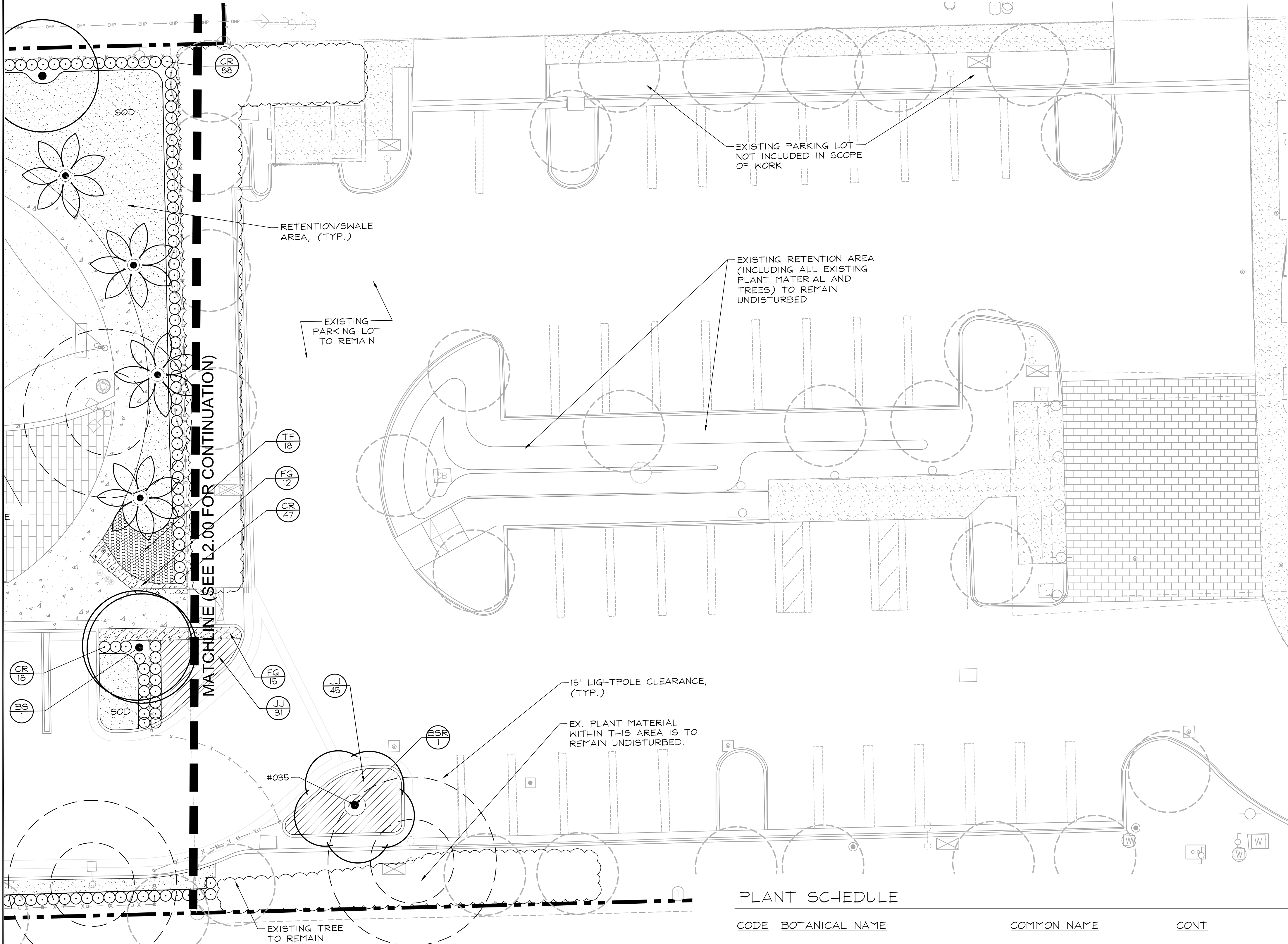

- PLANTING NOTES:**
- CONTRACTOR SHALL REFER TO THE LANDSCAPE PLANTING DETAILS, PLANT LIST, GENERAL NOTES AND ALL CONTRACT DOCUMENTS FOR FURTHER AND COMPLETE INSTRUCTIONS.
 - PLANT LIST QUANTITIES ARE PROVIDED FOR CONVENIENCE. IN THE EVENT OF QUANTITY DISCREPANCIES THE DRAINING SHALL TAKE PRECEDENCE. ANY DISCREPANCIES SHALL BE BROUGHT TO THE ATTENTION OF THE LANDSCAPE ARCHITECT PRIOR TO BIDDING.
 - PLANT SIZES LISTED ARE THE MINIMUM SIZE THAT WILL BE ACCEPTED FOR THAT PLANT.
 - ANY SUBSTITUTION IN SIZE AND/OR PLANT MATERIAL MUST BE APPROVED BY THE LANDSCAPE ARCHITECT IN WRITING. ALL PLANTS WILL BE SUBJECT TO APPROVAL BY LANDSCAPE ARCHITECT AND/OR OWNERS REPRESENTATIVE BEFORE PLANTING CAN BEGIN.
 - CONTRACTOR SHALL FIELD ADJUST LOCATION OF PLANT MATERIAL AS NECESSARY TO AVOID DAMAGE TO EXISTING UNDERGROUND UTILITIES AND/OR INTERFERE WITH EXISTING ABOVE GROUND ELEMENTS. ALL CHANGES REQUIRED SHALL BE COMPLETED AT THE CONTRACTOR'S EXPENSE AND SHALL BE COORDINATED WITH THE OWNER'S REPRESENTATIVE AND THE LANDSCAPE ARCHITECT.
 - THE CONTRACTOR SHALL BEAR ALL COSTS OF TESTING OF SOILS, AMENDMENTS, ETC. ASSOCIATED WITH THE WORK AND INCLUDED IN THE SPECIFICATIONS.
 - CONTRACTOR SHALL FAMILIARIZE HIM/HERSELF WITH THE LIMITS OF WORK AND EXISTING CONDITIONS AND VERIFY ALL INFORMATION. IF DISCREPANCIES EXIST, CONTRACTOR SHALL NOTIFY OWNER'S REPRESENTATIVE IN WRITING WITHIN SEVEN CALENDAR DAYS OF NOTICE TO PROCEED.
 - ALL NEW AND TRANSPLANTED PLANT MATERIAL SHALL BE IRRIGATED BY AN AUTOMATIC UNDERGROUND IRRIGATION SYSTEM.
 - ALL TREES DESIGNATED AS SINGLE TRUNK SHALL HAVE A SINGLE, RELATIVELY STRAIGHT, DOMINANT LEADER, PROPER STRUCTURAL BRANCHING AND EVEN BRANCH DISTRIBUTION. TREES WITH BARK INCLUSION, TIPPED BRANCHES, AND CO-DOMINANT TRUNKS WILL NOT BE ACCEPTED. TREES WITH GIRDLING, INTACT LEADER CIRCLING AND/OR PLUNGING ROOTS WILL BE REJECTED.
 - A PRE-CONSTRUCTION MEETING WITH URBAN FORESTRY IS REQUIRED BEFORE ANY WORK IS PERFORMED ON SITE.
 - ALL ROAD ROCK, CONCRETE, ASPHALT AND OTHER NON NATURAL MATERIAL SHALL BE REMOVED FROM ALL PLANTING AREAS PRIOR TO LANDSCAPE INSTALLATION AND BE REPLACED WITH PLANTING SOIL PRIOR TO LANDSCAPE INSTALLATION.

CODE REQUIREMENTS		
TOTAL PROJECT AREA: 32,234.4 SF (0.74 ACRES) IMPERVIOUS AREA: 23,130.4 SF (0.53 ACRES)		
ZONING: B-3 PERVIOUS AREA: 9,104 SF (0.21 ACRES)		
LAND USE: GENERAL BUSINESS		
	REQUIRED	PROVIDED
SEC. 155.5203.B.2.g.ii.(D).(3.) NO MORE THAN 50% OF TOTAL NUMBER OF REQUIRED TREES SHALL BE PALM TREES. 25 TOTAL TREES/PALMS x 50% = 12 PALMS MAX	12 PALMS MAX	10 PROP PALMS (PE)
SEC. 155.5203.C 1 TREE AND 5 SHRUBS PER 3,000 SQ FT OF PERVIOUS LOT AREA OR MAJOR FRACTION THEREOF 9,104 SF / 3,000 SF x 1 TREE = 3 TREES 9,104 SF / 3,000 SF x 5 SHRUBS = 15 SHRUBS	3 TREES 15 SHRUBS	25 PROPOSED TREE/PALMS + EXISTING/RELOCATED 773 SHRUBS
SEC. 155.5203.D.1.3.b PERIMETER LANDSCAPING STRIPS SHALL BE COMPRISED OF CANOPY TREES SPACED A MAXIMUM AVERAGE OF 30' ON CENTER NORTH: 175 LF / 30 LF x 1 TREE = 6 TREES SOUTH: 433 LF / 30 LF x 1 TREE = 15 TREES	6 TREES 15 TREES	5 PROPOSED TREES + 1 EX. PALMS/TREES 3 PROPOSED TREES + 15 EX. PALMS/TREES
SEC. 155.5203.D.1.4.b.iii EACH LANDSCAPE ISLAND SHALL CONTAIN AT LEAST 1 CANOPY TREE. UNDERSTORY TREES MAY BE SUBSTITUTED IN AREAS BENEATH OVERHEAD UTILITY LINES. 4 LANDSCAPE ISLANDS x 1 TREE = 4 TREES	4 TREES	4 TREES

PLANT SCHEDULE

CODE	BOTANICAL NAME	COMMON NAME	CONT	CAL	SIZE	NATIVE	DROUGHT TOL.	QTY
TREES								
BS	Bursera simaruba	Gumbo Limbo	F.G.	3" Cal.	16' HT x 5' SPR	Yes	Yes	2
BSR	Bursera simaruba	Gumbo Limbo	Relocated					2
CB	Conocarpus erectus f. sericeus	Silver Buttonwood	F.G.	2" Cal.	12' HT x 4' SPR	Yes	Yes	3
PE	Ptychosperma elegans	Alexander Palm	F.G.	16" OA		No	Yes	10
QV	Quercus virginiana	Southern Live Oak	F.G.	4" Cal.	16' HT x 6' SPR	Yes	Yes	7
TR	Tipu Tree	Tipuana Tipu	Relocated					1
SHRUBS								
AL	Aechmea blanchetiana 'Lemon'	Lemon Bromeliad	Cont.	24" O.C.	18" HT	No	Yes	10
CM	Codiaeum variegatum 'Mammy'	Mammy Croton	Cont.	24" O.C.	15"x15"	No	Yes	33
CR	Chrysobalanus icaco 'Red Tip'	Red Tip Coco Plum	Cont.	24" O.C.	24"x24"	Yes	Yes	390
DG	Duranta erecta	Golden Dewdrops	Cont.	24" O.C.	15"x15"	No	Yes	9
HF	Hibiscus rosa-sinensis 'Fiesta'	Fiesta Tropical Hibiscus	Cont.	24" O.C.	18"x18"	No	Yes	21
ZI	Zamia integrifolia	Coontie	30" HT. X 30" SPR.	30" O.C.				18
SHRUB AREAS								
FG	Ficus microcarpa 'Green Island'	Green Island Ficus	Cont.	24" O.C.	15"x15"	No	Yes	48
JJ	Jasminum volubile	Wax Jasmine	Cont.	24" O.C.	15"x15"	No	Yes	138
TF	Tripsacum dactyloides	Fakahatchee Grass	Cont.	30" O.C.	18" HT. X 18" SPR.	Yes	Yes	72
GROUND COVERS								
TS	Trachelospermum asiaticum 'Summer Sunset'	Summer Sunset Asiatic Jasmine	Cont.	12" O.C.	12"x12"	No	Yes	516
SOD/SEED								
SOD	Stenotaphrum secundatum 'Floratum'	Floratum St. Augustine Grass	Sod					± 4,761 sf



PROJECT LANDSCAPE ARCHITECT:

JAS C. HARGRETT,
Thomas C. Hargrett
LA 000000512
12/19/23

WALTERS
ZACKRIA
ARCHITECTS

5813 N. ANDREWS WAY
FORT LAUDERDALE, FL 33309
PHONE: (954) 522-4123
FAX: (954) 522-4128
www.wza-architects.com

Abbas H. Zackria, FL AR 91520

CORPORATE NAME: WALTERS, ZACKRIA ASSOCIATES, PLLC REGISTERED IN THE STATE OF FLORIDA. WRITTEN DIMENSIONS TAKE PRECEDENCE OVER SCALED DIMENSIONS. THESE DRAWINGS ARE THE PROPERTY OF WALTERS, ZACKRIA ASSOCIATES, PLLC, AND SHALL NOT BE REPRODUCED WITHOUT WRITTEN PERMISSION FROM A PRINCIPAL OF THE FIRM OR BE LIABLE FOR THE FULLEST LEGAL RECOURSE. CONTRACTOR SHALL VERIFY ALL EXISTING CONDITIONS AND DIMENSIONS AND NOTIFY THE ARCHITECT OF ANY DISCREPANCIES PRIOR TO EXECUTION OF WORK.

CITY OF POMPANO BEACH
CHARLOTTE BURRIE COMM. CENTER
PLAZA AND PASSIVE PARK

2669 N FEDERAL HWY,
POMPANO BEACH, FL 33064

DRAWN BY: BM
CHECKED BY: TH
DATE: 12-22-2023

REVISIONS:
△ 10-23-23 PERMIT CO-ORD
△ 12-22-23 PERMIT CO-ORD
△
△
△
△

2203

L2.10

LANDSCAPE PLAN

AAC
PZ23-12000041
02/06/2024